

Briefed with the idea of "The Super intelligent Design Concept" Sanji engineers developed the ZX Range of professional vehicle security alarm and immobiliser systems. The SL range represents the 'state of the art' in vehicle security. Read these instructions for correct system operation. All points marked * are optional features.

1) SETTING THE ALARM

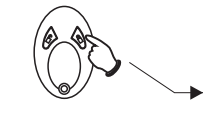

To enable the immobiliser and full alarm features.

Press the lock button, the unit will sound 2 soft chirps and the indicators will flash twice. If fitted with central locking the doors will lock and the sensor will switch on.

2) DOOR / BOOT / BONNET OPEN WARNING



To warn the driver that a door or boot is open when setting the alarm.

The unit will sound two additional loud chirps and flash the indicators twice when setting the alarm. If a door is still open when the unit fully arms, the doors will be bypassed. The system will assume a faulty door switch.

3) ALARM DELAY PERIOD



25 second arming delay.

The dash led will flash rapidly during the 20 second delay period. After the delay, the dash led will start to flash slowly. The alarm and immobiliser is now fully armed.

4) ALARM FAST ARM

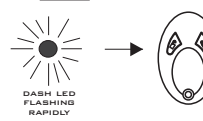

To skip the 25 second delay period.

After the alarm has been set press the lock button again. The unit will now go to fully armed and the dash led will flash slowly.

5) ALARM ARMED CONFIRMATION

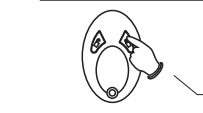

To confirm alarm armed mode.

Press the lock button, the indicators will flash once to confirm that the alarm is fully set.

6) SENSOR SHUT DOWN

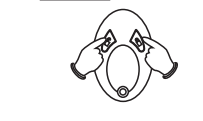

To disable the interior sensor so that a pet or person can remain inside the vehicle when the alarm is set.

Press both buttons together when setting the alarm. The siren will sound 4 loud chirps and the indicators will flash twice. The sensor has now been disabled (green LED will turn off). After 25 seconds the system will be fully armed.

7) RESET THE ALARM

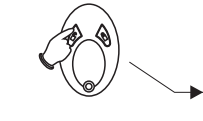

To reset the immobiliser and alarm.

Press the unlock button. The unit will sound 1 soft chirp and the indicators will flash once. If fitted with central locking the doors will unlock.

8) SELECTIVE UNLOCK ON ALARM RESET



* To reset the alarm and open the driver's door only.

To reset the alarm and open the driver's door only.

Press the unlock button. The unit will reset and selectively only open the driver's door. To open the passenger doors press the unlock button again.

9) AUTO ZONE BYPASS



Auto-matically bypass a defective zone.

Auto-matically bypass a defective zone.

If the unit detects a permanently faulty zone, e.g. door or sensor during alarm set, the system will sound 3 times then isolate the faulty zone.

10) VIOLATION CHIRPS



To indicate to user that the alarm has triggered in his/her absence.

To indicate to user that the alarm has triggered in his/her absence.

When the alarm is reset, the unit will sound 4 loud chirps if the alarm had triggered during the alarm set mode.

11) STARTING THE VEHICLE



To start the vehicle after the alarm has been reset.

To start the vehicle after the alarm has been reset.

When the alarm is reset the dash led will be off. The vehicle can be started within 30 seconds. After 30 seconds the immobiliser will be armed, dash led on. Press the unlock button the dash led will turn off, the vehicle can now be started.

12) DOOR LOCK ON START

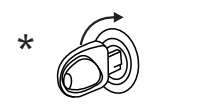

* Automatic locking of all doors when ignition is turned on.

Automatic locking of all doors when ignition is turned on.

When the ignition is turned on, if all the doors, boot and bonnet are closed, the doors will lock.

13) DOOR LOCK / UNLOCK IN DRIVE

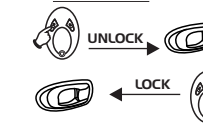

To lock or unlock the doors from the remote while the car is running.

To lock or unlock the doors from the remote while the car is running.

Press the unlock button to unlock the doors. Press the lock button to lock the doors.

14) DOOR UNLOCK ON IGNITION OFF



* To open the doors when the ignition is turned off.

To open the doors when the ignition is turned off.

Switch the ignition off. All the doors will unlock. If fitted with selective unlock, only the driver's door will open. Press the unlock button to open the passenger doors.

15) REMOTE PANIC

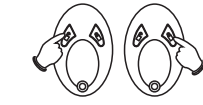

To enable the siren to sound and the indicators to flash under emergency conditions.

To enable the siren to sound and the indicators to flash under emergency conditions.

Press either button continuously for +/- 3 seconds. When in panic, the unit can be driven. Press the unlock button to reset panic.

16) HI-JACK SERVICE MODE

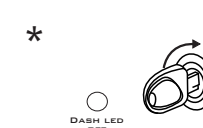

* To temporarily disable hi-jack.

To temporarily disable hi-jack.

In drive, (ignition on, dash led off), press the lock and unlock buttons simultaneously, the siren will chirp once. Hi-jack is now disabled. When the ignition is turned on to drive, the unit will flash the indicators once to warn the user that the unit is in hi-jack service mode. To reactivate hi-jack repeat the above procedure, the siren will chirp twice.

17) FORCED HI-JACK MODE



* Forced hi-jack in drive.

Forced hi-jack in drive.

When you start the vehicle, the unit will enter hi-jack, the dash led will give a 1 second pulse. Refer to point 21 to reset hi-jack. If you start the vehicle with the hidden button pressed, the unit will not enter forced hi-jack.

18) DRIVER'S DOOR HI-JACK



* To activate hi-jack.

To activate hi-jack.

In drive open then close driver's door. If all doors, bonnet and boot are closed the dash led will give a 1 second pulse. The unit has entered hi-jack phase.

19) HI-JACK OPERATION

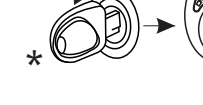

* Hi-jack mode.

Hi-jack mode.

Countdown period is 90 sec. If ignition is turned off during this time, the timer will stop. When the ignition is turned on again the timer will continue. If you try to set the alarm during the countdown period, the unit will sound 4 loud chirps to warn you that you are in hi-jack mode.

20) HI-JACK WARNING PERIOD



* Hi-jack warning mode.

Hi-jack warning mode.

After the countdown period the unit will enter the 20second warning period. The unit will chirp and flash the indicators. After this period the unit will enter the 8 second slow down period. At any point in time you can reset hi-jack by pressing the hidden button.

21) RESET HI-JACK



* To reset the unit back to normal drive mode.

To reset the unit back to normal drive mode.

Press the hidden push button at any time for +/- 2 seconds, the unit will chirp once to confirm that hi-jack has been reset.

22) FINAL HI-JACK



* To confirm what phase the unit is in.

To confirm what phase the unit is in.

In final hi-jack the siren will sound on and off at 5 second intervals and the indicators will flash. The immobiliser will be armed. The unit can be reset by pushing the hidden button for +/- 2 seconds.

23) ONE EVENT OVERRIDE

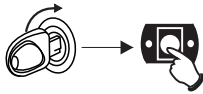

To override the immobiliser or alarm, in the event of a flat remote battery.

In any mode, turn the Ignition on and press the hidden push button for +/- 2 seconds until the unit chirps once, the system will be reset. This is a once off override.

24) PERMANENT OVERRIDE

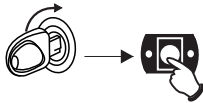

To put the unit into permanent override.

In drive mode, press and hold the hidden button (+/-10sec) until the unit chirps once. The unit is now in permanent override. The dash led will flash continuously. The alarm and immobiliser features will now be dormant. If you try to set the alarm you will hear 8 chirps. Repeat this procedure to exit service mode.

25) I WIRE OVERRIDE

(speak to your fitment center)



To put the unit into permanent override.

NB: function only active when Override wire connected. Once override wire is connected turn the ignition on and wait 2 seconds until the unit chirps once. The unit is now in permanent override. The dash led will flash continuously. The alarm and immobiliser features will now be dormant. If you try to set the alarm you will hear 8 chirps. Simply disconnect the override wire to exit service mode.

26) REMOVE SET/RESET CHIRPS



Set / reset chirps OFF.

In drive mode press the hidden button and turn the ignition off immediately. Continue to press the button until the unit chirps once. The set / reset chirps have now been removed. To turn the set / reset chirps back on repeat the above procedure, the unit will chirp twice.

27) CARFINDER



Light up the surrounding area after unlocking the vehicle

NB: Hardwire fitment option. Press the unlock button (ignition off). The vehicle will unlock and turn the headlights or indicators or interior dome light on for 15 seconds. The lights will switch off if ignition is switched on within the 15 seconds.

28) AUTO ARM / AUTO REARM

Automatically arm the vehicle and protect your valuables against frequency jammers

Once the auto arm feature has been activated, the S1300 will auto arm from any state after 30 seconds.

1. From Set - If the alarm was set and the unlock button was pressed with no doors opened, the alarm will set the alarm and lock the doors.

2. From Set - If the alarm was set and the unlock button was pressed with a door opened, the alarm will set the alarm but not lock the doors.

3. From Drive - once ignition is turned off, the alarm will wait for the first door to be opened then start the auto arm process.

NB: The driver can sit in the vehicle without the alarm arming as long as the ignition is on. The ACC (accessory) setting on the key switch does not provide the ignition state required, the auto arm feature will start if ignition is turned to ACC.

The auto arm function looks for movement in the vehicle and will always auto arm your vehicle. If you want to lock your vehicle with someone or an animal in the vehicle, lock the vehicle using the sensor shutdown option*.

*refer to point 6 of this manual.

FITMENT CENTER STAMP:

SL300-USER-REVO

Specifications subject to change without notice.

S1300

ISO9001
Quality Company



SANJI SECURITY SYSTEMS (PTY) LTD
106 16TH ST MIDRAND GAUTENG, SOUTH AFRICA
TEL +27 11 266 7500 FAX +27 11 266 7501
E Mail : sales@sanji.co.za <http://www.sanji.co.za>